

Fixings @ 200/300 centres at sheet edges and over studs/nogs

Fixings @ 200/300 centres at sheet edges and over studs/nogs

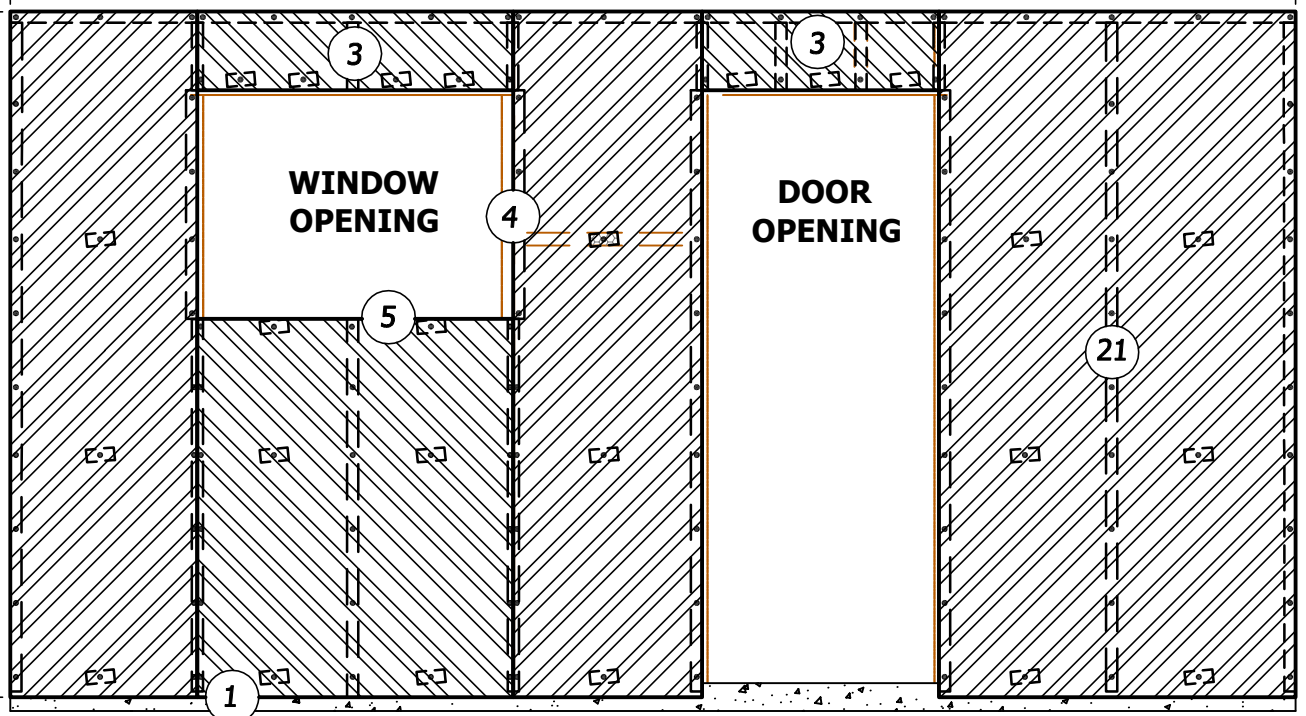

Note: Low, medium and high wind zones require nailing over structural framing at 300mm centres. Very high wind zones require nailing over structural framing at 200mm centres

Supercoat Sticky Mesh reinforcing butterflies

Supercoat Grid Mesh reinforcing to entire wall

Around Meterbox

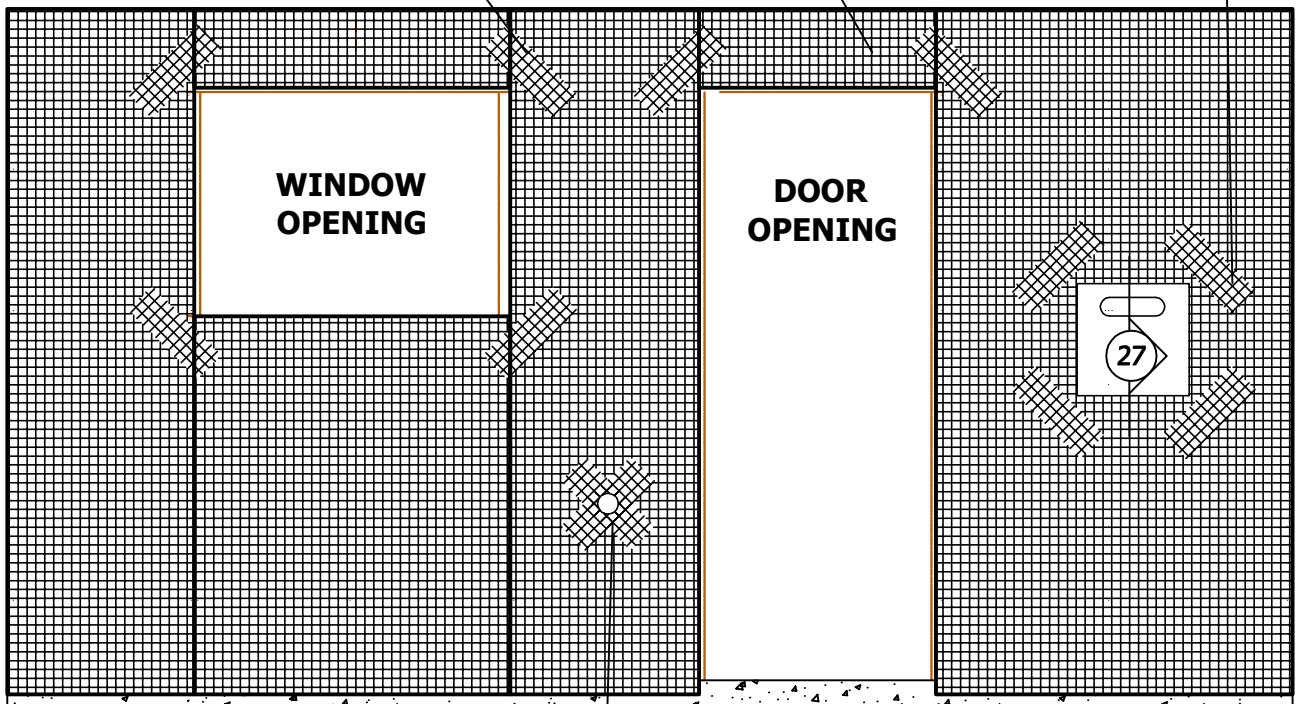

Around pipe penetrations



Title:

EPS and Mesh Layouts

Date. February 2018

Detail No. PP 2-0

This drawing must be read in conjunction with the Plasterpol Drained & Ventilated Facade Design Guide